

10/2/2024 9:52 AM

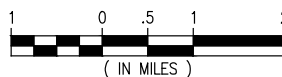

VICINITY MAP

SCALE: 1" = 2 MILES



JEFFERSON COUNTY
LAT. 29° 55' 50" N
LONG. 93° 52' 31" W

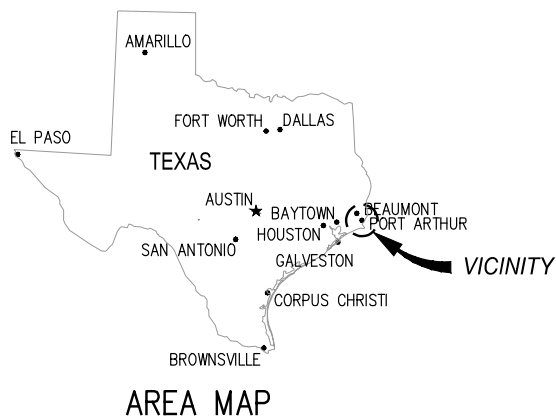

AREA MAP

JOSEPH E. LOOMIS P.E.
TX PE #126343

PRELIMINARY - FOR PERMITTING PURPOSES ONLY, NOT FOR CONSTRUCTION

REV
A



**LANIER & ASSOCIATES
CONSULTING ENGINEERS, INC.**

LA: EF-1120
VF-185

TX: F-2981
LSF-10194817

NEW ORLEANS • BEAUMONT • CORPUS CHRISTI • HOUSTON • MANDEVILLE

KANSAS CITY SOUTHERN RAILROAD
PORT ARTHUR TEXAS

**PABTEX DOCK
PROPOSED MAINTENANCE DREDGE
VICINITY MAP AND AREA MAP**

DATE	APR.'24
DESIGN	*
DRAWN	ADG
CHECK	HMS
JOB NO	12607
SHEET No.	
	1 OF 7

J:\120005\12607 PABTEX DREDGE RENEWAL DRAWINGS\PERMIT\12607-P1.DWG

10/2/2024 9:52 AM



LOCATION MAP

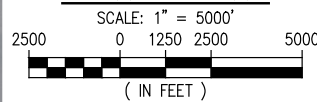

JOSEPH E. LOOMIS P.E.
TX PE #126343

PRELIMINARY - FOR PERMITTING PURPOSES ONLY, NOT FOR CONSTRUCTION

REV
A

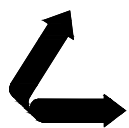

**LANIER & ASSOCIATES
CONSULTING ENGINEERS, INC.**

LA: EF-1120
VF-185

TX: F-2981
LSF-10194817

NEW ORLEANS • BEAUMONT • CORPUS CHRISTI • HOUSTON • MANDEVILLE

KANSAS CITY SOUTHERN RAILROAD
PORT ARTHUR TEXAS

**PABTEX DOCK
PROPOSED MAINTENANCE DREDGE
LOCATION MAP**

DATE	APR. '24
DESIGN	*
DRAWN	ADG
CHECK	HMS
JOB NO	12607
SHEET No.	
	2 OF 7

10/2/2024 9:54 AM



J:\120005\12607 PABTEX DREDGE RENEWAL DRAWINGS\PERMIT\12607-P3.DWG

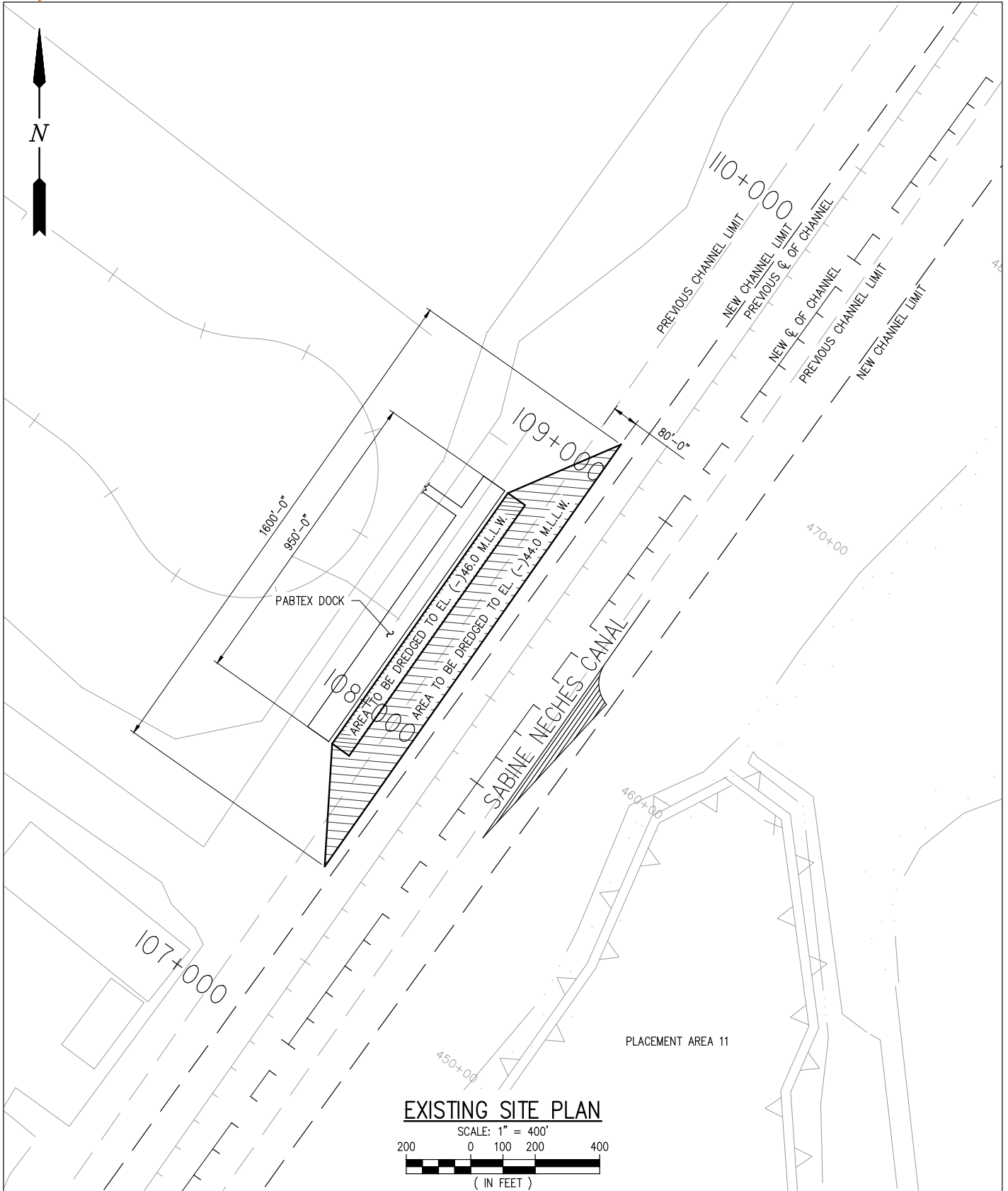

JOSEPH E. LOOMIS P.E.
TX PE #126343

PRELIMINARY - FOR PERMITTING PURPOSES ONLY, NOT FOR CONSTRUCTION

REV
A



LANIER & ASSOCIATES
CONSULTING ENGINEERS, INC.

LA: EF-1120 TX: F-2981
VF-185 LSF-10194817

NEW ORLEANS • BEAUMONT • CORPUS CHRISTI • HOUSTON • MANDEVILLE

KANSAS CITY SOUTHERN RAILROAD
PORT ARTHUR TEXAS

PABTEX DOCK
PROPOSED MAINTENANCE DREDGE
EXISTING SITE PLAN

DATE	APR.'24
DESIGN	*
DRAWN	ADG
CHECK	HMS
JOB NO	12607
SHEET No.	
	3 OF 7

10/2/2024 9:56 AM



NOTE:

1. DEEPENING OF BERTH IS SUBJECT TO STRUCTURAL ANALYSIS TO DETERMINE DOCK STABILITY AT PROPOSED DREDGE DEPTHS.

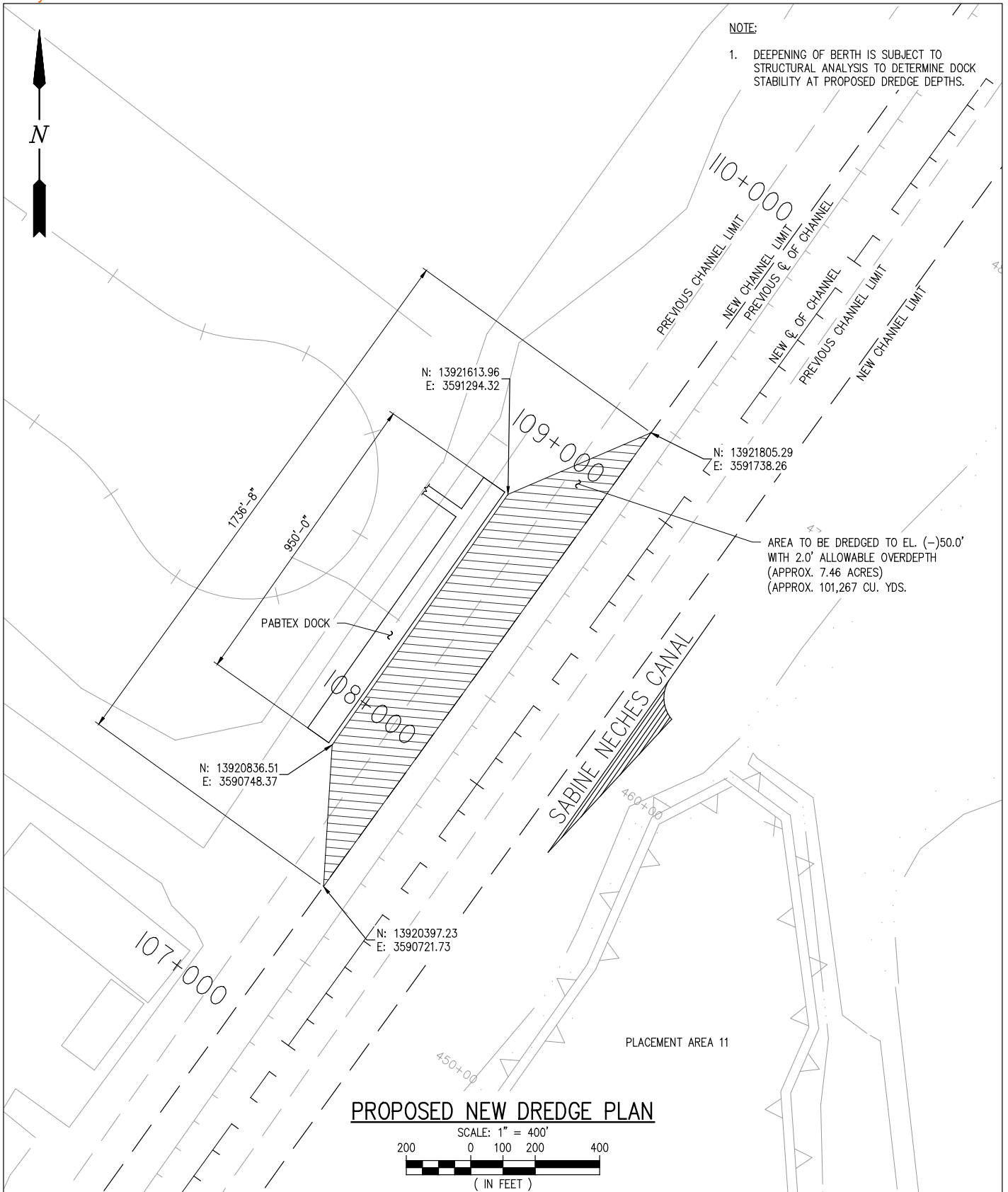

PROPOSED NEW DREDGE PLAN

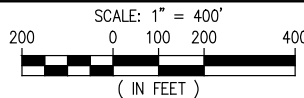

JOSEPH E. LOOMIS P.E.
TX PE #126343

PRELIMINARY - FOR PERMITTING PURPOSES ONLY, NOT FOR CONSTRUCTION

REV
A



**LANIER & ASSOCIATES
CONSULTING ENGINEERS, INC.**

LA: EF-1120 TX: F-2981
VF-185 LSF-10194817

NEW ORLEANS • BEAUMONT • CORPUS CHRISTI • HOUSTON • MANDEVILLE

KANSAS CITY SOUTHERN RAILROAD
PORT ARTHUR TEXAS

**PABTEX DOCK
PROPOSED MAINTENANCE DREDGE
PROPOSED NEW DREDGE PLAN**

DATE APR.'24
DESIGN *
DRAWN ADG
CHECK HMS
JOB NO 12607
SHEET No.
4 OF 7

J:\120005\12607 PABTEX DREDGE RENEWAL DRAWINGS\PERMIT\12607-P4.DWG

10/2/2024 9:56 AM

J:\120005\12607 PABTEX DREDGE RENEWAL\DRAWINGS\PERMIT\12607-P5.DWG

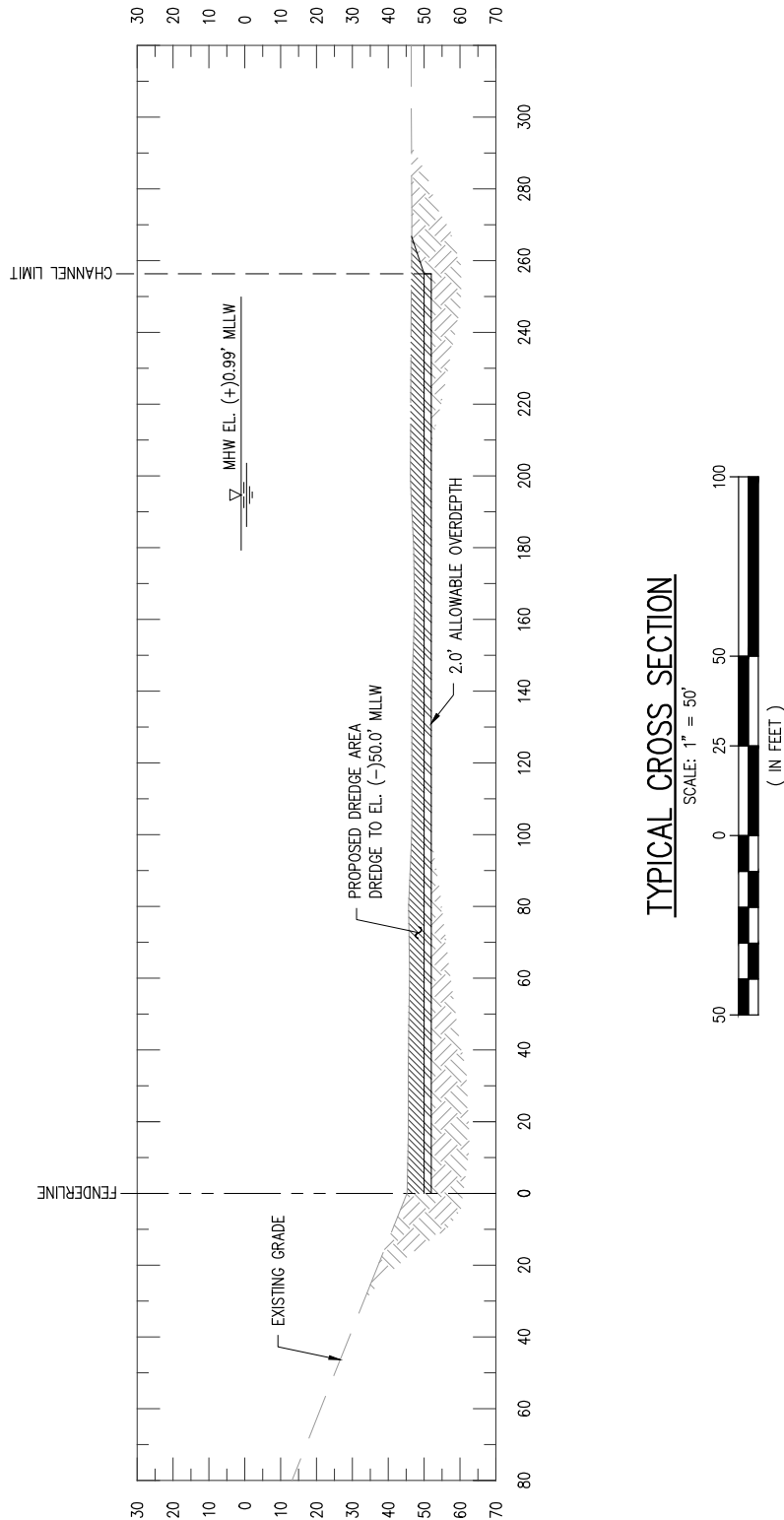

NOTE:

1. MHW EL. (+)0.99' = 0.00' MLLW
2. EXISTING CONSTRUCTION AND CONDITIONS ARE SCHEMATIC. ACTUAL CONDITIONS MAY DIFFER. THE CONTRACTOR IS FULLY RESPONSIBLE FOR MAKING HIS OWN SITE EXAMINATION AND DETERMINING THE ACTUAL NATURE AND EXTENT OF EXISTING CONDITIONS AS NEEDED PRIOR TO UNDERTAKING THE WORK.

JOSEPH E. LOOMIS P.E.
TX PE #126343

PRELIMINARY - FOR PERMITTING PURPOSES ONLY, NOT FOR CONSTRUCTION

REV
A

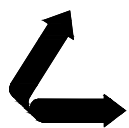

LANIER & ASSOCIATES
CONSULTING ENGINEERS, INC.

LA: EF-1120 TX: F-2981
VF-185 LSF-10194817

NEW ORLEANS • BEAUMONT • CORPUS CHRISTI • HOUSTON • MANDEVILLE

KANSAS CITY SOUTHERN RAILROAD
PORT ARTHUR TEXAS

PABTEX DOCK
PROPOSED MAINTENANCE DREDGE
TYPICAL CROSS SECTION

DATE APR.'24
DESIGN *
DRAWN ADG
CHECK HMS
JOB NO 12607
SHEET No.
5 OF 7

10/2/2024 9:57 AM



PLACEMENT AREA OVERALL SITE PLAN

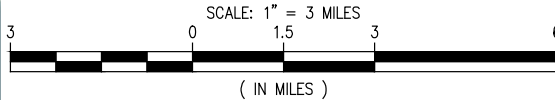

JOSEPH E. LOOMIS P.E.
TX PE #126343

PRELIMINARY - FOR PERMITTING PURPOSES ONLY, NOT FOR CONSTRUCTION

REV
A



LANIER & ASSOCIATES
CONSULTING ENGINEERS, INC.

LA: EF-1120
VF-185

TX: F-2981
LSF-10194817

NEW ORLEANS • BEAUMONT • CORPUS CHRISTI • HOUSTON • MANDEVILLE

KANSAS CITY SOUTHERN RAILROAD
PORT ARTHUR TEXAS

PABTEX DOCK
PROPOSED MAINTENANCE DREDGE
PLACEMENT AREA OVERALL SITE PLAN

DATE	APR '24
DESIGN	*
DRAWN	ADG
CHECK	HMS
JOB NO	12607
SHEET No.	
6	OF 7

10/2/2024 9:58 AM



PRIVATE PLACEMENT AREA PLAN

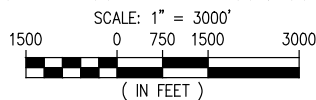

JOSEPH E. LOOMIS P.E.
TX PE #126343

PRELIMINARY - FOR PERMITTING PURPOSES ONLY, NOT FOR CONSTRUCTION

REV
A



LANIER & ASSOCIATES
CONSULTING ENGINEERS, INC.

LA: EF-1120 TX: F-2981
VF-185 LSF-10194817

NEW ORLEANS • BEAUMONT • CORPUS CHRISTI • HOUSTON • MANDEVILLE

KANSAS CITY SOUTHERN RAILROAD
PORT ARTHUR TEXAS

PABTEX DOCK
PROPOSED MAINTENANCE DREDGE
PRIVATE PLACEMENT AREA PLAN

DATE	APR.'24
DESIGN	*
DRAWN	ADG
CHECK	HMS
JOB NO	12607
SHEET No.	7 OF 7

J:\120005\12607 PABTEX DREDGE RENEWAL DRAWINGS\PERMIT\12607-P7.DWG